

**BRIDGEND COUNTY BOROUGH COUNCIL (PROHIBITION AND RESTRICTION OF WAITING AND LOADING AND PARKING PLACES) (CONSOLIDATION) ORDER 2024**

**AMENDMENT ORDER No.2 202-**

**WHEREAS** the Bridgend County Borough Council (hereinafter referred to as “the Council”) hereby make the following Order in exercise of their powers under Sections (1), 2(1) to (2), 4,124(1) and Part IV of Schedule 9 of the Road Traffic Regulation Act 1984 (the Act of 1984), as amended, the Traffic Management Act 2004 and of all other enabling powers and after consultation with the Chief Officer of Police and in accordance with Part III of Schedule 9 to the Act of 1984 to amend the BRIDGEND COUNTY BOROUGH COUNCIL (PROHIBITION AND RESTRICTION OF WAITING AND LOADING AND PARKING PLACES) (CONSOLIDATION) ORDER 2024, as amended, (“the Consolidation Order”), the effect of which will be:-

1. Revoke the Order Plan specified in Column 1 of the Schedule to this Order and insert the revised Order Plan specified in Column 2 of the Schedule to this Order in substitution.
2. The Order Plan specified in Column 2 of the Schedule to this Order is from the date that this Order takes effect incorporated into “the Plans” as defined in the Consolidation Order and contained in Schedule 1 of the Consolidation Order.
3. *Schedule 2 of the Consolidation Order is amended as follows:-*
  - (i) *by the deletion of the wording ‘L75 ’ and the insertion in substitution of the wording ‘L75 Rev 1’ and from the date this Order takes effect Schedule 2 of the Consolidation Order shall be read and construed accordingly.*
4. Insofar as any provision of this Order conflicts with a provision which is contained in an Order made or having effect as if made under the Act and existing at the time when this Order comes into operation and which imposes a restriction on vehicles in the lengths of roads and sides of lengths of roads delineated on the Order Plans specified in the Schedule of this Order that provision of this Order shall prevail.
5. The restrictions prohibitions and requirements imposed by this Order shall be in addition to and not in derogation from any restriction or requirements imposed by any regulations or Order made or having effect as if made under the Act or by or under any other enactment.
6. Any reference in this Order to any enactment shall be construed as a reference to that enactment as amended, applied, consolidated, re-enacted by or as having effect by virtue of any subsequent enactment.
7. The Interpretation Act 1978 shall apply to the interpretation of this Order as it applies to the interpretation of an Act of Parliament.

8. This Order shall come into force on the 00/00/202 and may be cited as the **BRIDGEND COUNTY BOROUGH COUNCIL (PROHIBITION AND RESTRICTION OF WAITING AND LOADING AND PARKING PLACES) (CONSOLIDATION) ORDER 2024**  
**AMENDMENT ORDER No.2 202-- .**

Dated this                      day of                      202-

**THE COMMON SEAL of BRIDGEND**                      )  
**COUNTY BOROUGH COUNCIL**                      )  
was hereunto affixed in the presence of:-                      )

Authorised Signatory:

<u>SCHEDULE</u>			
<u>Column One</u>		<u>Column Two</u>	
<u>Map Schedule</u>	<u>Date</u>	<u>Map Schedule</u>	<u>Date</u>
1. L75	29.11.2024	L75 REV 1	**

\*\* date inserted when order made

This document is available in Welsh / Mae'r ddogfen hon ar gael yn Gymraeg

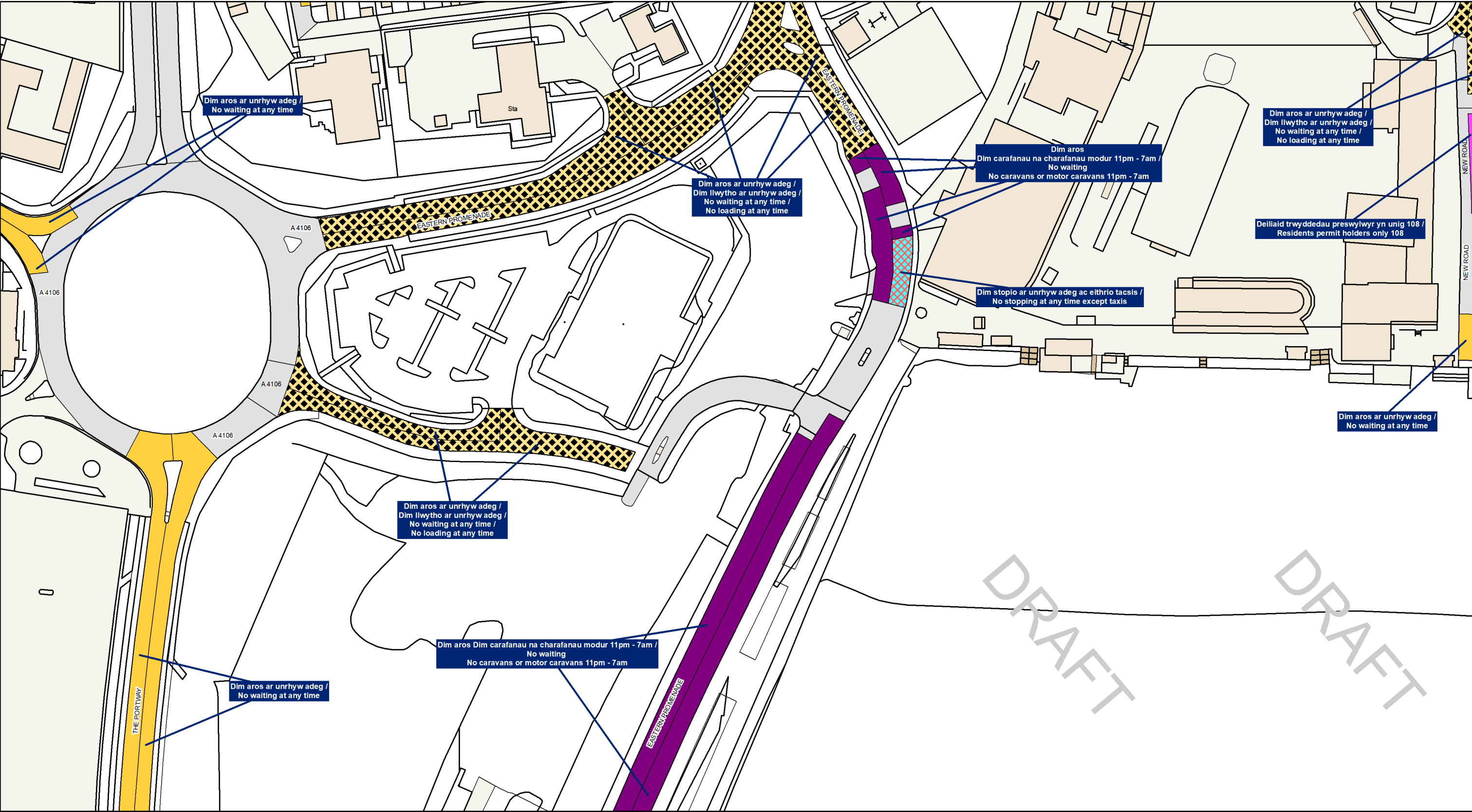

Cyngor Bwrdeistref Sirol  
**Pen-y-bont ar Ogwr**  
**BRIDGEND**  
County Borough Council

**Ffordd Llyn Halen (Aldi Access Road)**

©Hawlfraint a hawliau cronfa ddata'r Goron 2025. Rhif Trwydded yr Arolwg Ordnans AC0000851951  
©Crown Copyright and database right 2025. Ordnance Survey AC0000851951

Allwedd Cyfyngu / Restriction Key			
Dim Aros Unrhyw Bryd No Waiting At Any Time	Dim Aros Unrhyw Bryd / Dim Llwytho Unrhyw Bryd No Waiting At Any Time / No Loading At Any Time	Deiliaid Bathodyn Anabledd Yn Unig Disabled Badge Holders Only	Dim Aros Unrhyw Bryd / Dim Llwytho No Waiting At Any Time / No Loading
Dim Aros / Dim Llwytho No Waiting / No Loading	Cyfyngiad Defnydd Ddeuol Dual Use Restriction	Ysgol Cadw Clir School Keep Clear	Llwytho Yn Unig Loading Only
Deiliaid Trwydded Yn Unig Permit Holders Only	Cyfyngiad Amrywiol Miscellaneous Restriction	Cyfyngiad Parthol Zonal Restriction	Clirffyrdd Clearways
Aros Cyfyngedig Limited Waiting		Ffin BCBC BCBC Boundary	

**DYDDIAD DATE**  
**TBC**

**GRADDFA SCALE**  
**1:1,250**

**RHIF Y MAP MAP NUMBER**  
**L75 Rev 1**