

ADIT NOTES

1. IT IS BELIEVED THAT THE MINING ADIT MOUTH IS CURRENTLY DRAINED VIA A POSITIVE GRAVITY DRAINAGE CONNECTION TO THE EXISTING SITE SURFACE WATER SYSTEM TO THE SOUTH.
2. CONTRACTOR TO LOCATE POSITION OF ADIT ON SITE DOWNSTREAM OF POINT A VIA EXCAVATION OF TRIAL TRENCHES TAKING PRECAUTIONS FOR POSSIBLE PRESENCE OF MINE GAS. INDICATIVE DEPTH TO INVERT 8m.
3. CONTRACTOR TO DETERMINE (SURVEY) ROUTE OF EXISTING DRAIN CONNECTING THE ADIT TO THE RIVER.
4. ROUTE OF ADIT UPSTREAM OF POINT A TO BE TRACED ON SITE.
5. MANHOLE TO BE CONSTRUCTED ON LINE OF ADIT ADJACENT TO SITE BOUNDARY (INDICATIVE POSITION POINT B).
6. MANHOLE TO BE CONSTRUCTED ON LINE OF ADIT (INDICATIVE POINT A). A NEW SURFACE WATER CONNECTION TO BE PROVIDED FROM POINT A TO THE RIVER.
7. NEW PIPE TO BE POSITIONED IN ADIT BETWEEN POINTS A AND B AND ADIT FILLED/GROUTED UP OVER THIS LENGTH.

MINESHAF T NOTES

1. EXISTING MINESHAF T PREVIOUSLY CAPPED TO UNKNOWN SPECIFICATION.
2. CONTRACTOR TO LOCATE POSITION OF AND EXPOSE MINESHAF T ON SITE VIA EXCAVATION OF TRIAL TRENCHES.
3. METHOD OF EXCAVATION TO BE PLANNED TO MITIGATE RISK OF COLLAPSE IF EXISTING CAP IS MISSING OR INSECURE AND FOR THE POSSIBLE PRESENCE OF MINE GAS.
4. MINESHAF T CAP TO BE CORED TO DETERMINE SPECIFICATION.
5. FORM OF REMEDIATION WORKS (EG GROUTING/CAPPING/CONCRETE PLUG) IF REQUIRED TO BE AGREED WITH BRIDGEND COUNTY BOROUGH COUNCIL/COAL AUTHORITY.
6. GROUND OVER MINESHAF T TO BE BACKFILLED AND FILL MATERIAL THOROUGHLY COMPACTED.

SITE WIDE REMEDIATION NOTES

1. THE CONTRACTOR IS TO REMEDIATE WITHIN THE EXTENT OF THE SITE BOUNDARY REMOVING EXISTING BUILDING SLABS, SERVICE YARDS AND ACCESS ROAD, REDUNDANT DRAINAGE, BURIED OBSTRUCTIONS AND CONTAMINATION.
2. EXISTING CONCRETE SLABS AND FOUNDATIONS TO BE BROKEN OUT.
3. CONTRACTOR TO EXCAVATE TOP 1.5m (AVERAGE) DEPTH OF MATERIAL ON SITE REMOVING BURIED OBSTRUCTIONS AND REDUNDANT DRAINAGE. MATERIAL TO BE PROCESSED FOR REUSE WITH ANY CONTAMINATED/UNSUITABLE MATERIAL DISPOSED OF OFF SITE.
4. SUITABLE EXCAVATED MATERIAL TO BE SPREAD AND COMPACTED ACROSS THE WHOLE SITE.
5. DISTINCTIVE GEOTEXTILE SEPARATING MEMBRANE TO BE PLACED ON TOP OF COMPACTED SITE-WON PROCESSED FILL MATERIAL.
6. CLEAN SITE-WON CONCRETE TO BE CRUSHED AND INCORPORATED INTO 450mm CAPPING LAYER AUGMENTED WITH IMPORTED SUITABLE CLEAN INERT MATERIAL.
7. PRELIMINARY SITE LEVEL STRATEGY ARE TO BE +600mm IN LINE WITH CAPPING REQUIREMENTS
8. TEMPORARY LAND DRAINAGE TO BE PROVIDED AS APPROPRIATE

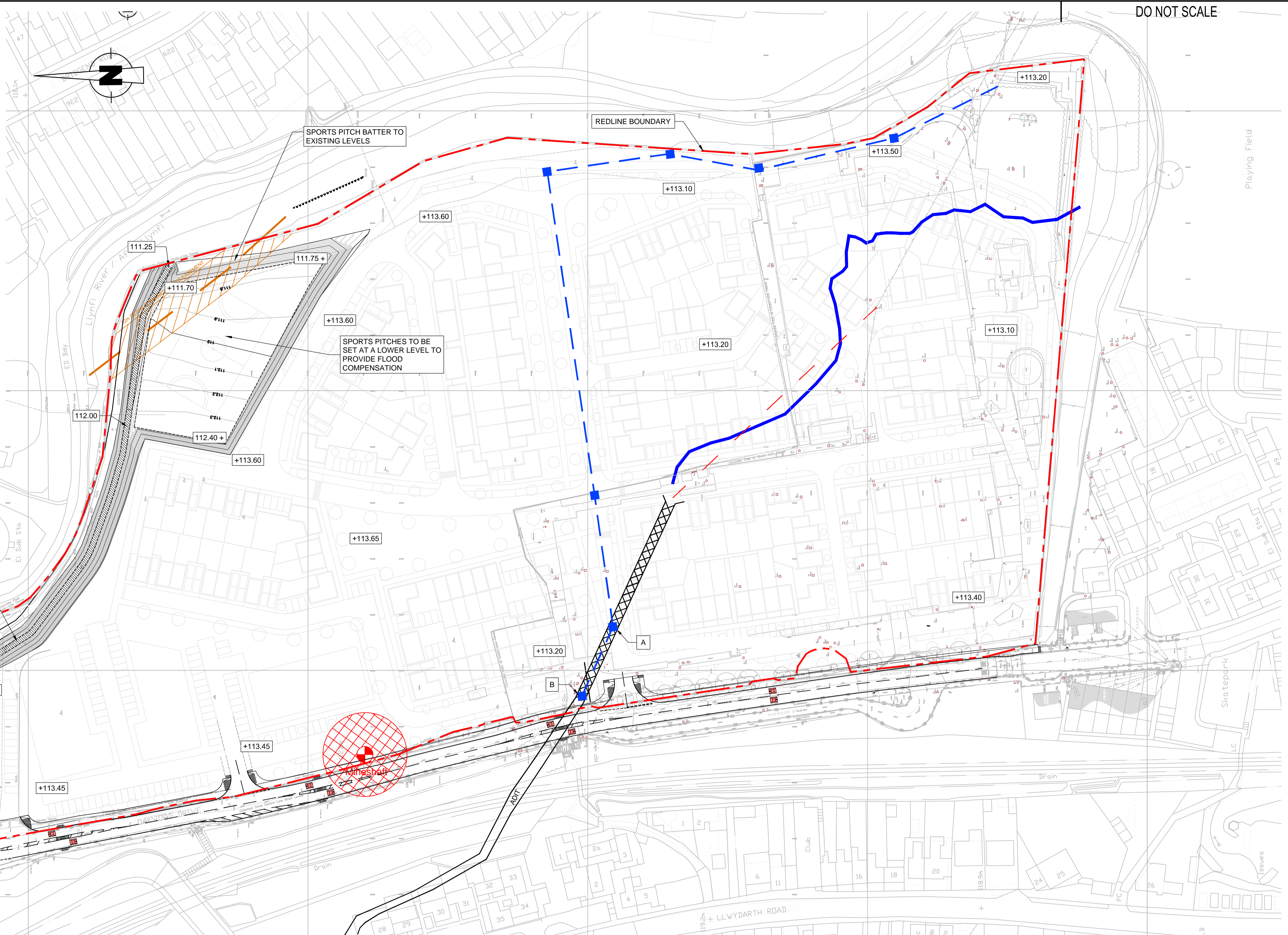

FLOOD ALLEVIATION CHANNEL TO EXTEND TO A LEVEL OF 113.00 TO 3M MAINTENANCE TRACK ON EASTERN BANK OF CHANNEL

FINISHED LEVELS TO ACCESS ARE TO BE LOWERED TO ALLOW EXISTING OVERLAND FLOWS ENTERING THE SITE TO BE DIRECTED TO THE PROPOSED FLOOD ALLEVIATION CHANNEL.

PROPOSED 1:3 BANK TO GRADE UPTO REMEDIATED LEVELS

Mineshaft

UNTIL TECHNICAL APPROVAL HAS BEEN OBTAINED FROM THE RELEVANT LOCAL AUTHORITIES OR STATUTORY BODIES, IT SHOULD BE UNDERSTOOD THAT ALL DRAWINGS ARE ISSUED AS PRELIMINARY AND NOT FOR CONSTRUCTION. SHOULD THE CONTRACTOR AND / OR EMPLOYER COMMENCE WORK PRIOR TO APPROVAL BEING GIVEN, IT IS ENTIRELY AT THEIR OWN RISK

KEY

| | |
|---------|--------------------------------------|
| +112.20 | PRELIMINARY REMEDIATED LEVELS (mAOD) |
|---------|--------------------------------------|

- NOTES**
1. ALL DIMENSIONS ARE IN METRES UNLESS STATED OTHERWISE.
 2. ALL LEVELS ARE IN METRES RELATED TO ORDNANCE SURVEY GPS NETWORK

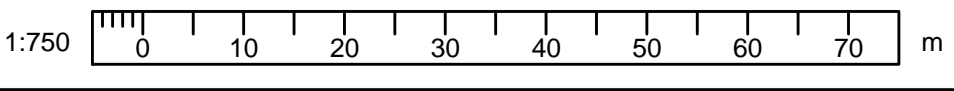

| REV | DATE | BY | DESCRIPTION | CHK | APP |
|-----|------------|-----|--|-----|-----|
| P02 | 07/11/2022 | ADW | SOUTHERNMOST ACCESS REMOVE IN LINE WITH UPDATED MASTERPLAN | ADW | ARW |
| P01 | 17/08/2022 | DRG | FIRST ISSUE | ADW | ARW |

DRAWING STATUS: S2 - FOR INFORMATION

1 Capital Quarter
Tyndall St
Cardiff
CF10 4BZ, UK

T+ 44 (0) 292 076 9200
wsp.com

CLIENT:
PONTARDAWE COAL & METALS LTD

ARCHITECT:
POWELL DOBSON ARCHITECTS

PROJECT:
EWENNY ROAD, MAESTEG

TITLE:
SITE REMEDIATION WORKS

| | | |
|---|------------------|----------------------|
| SCALE @ A1: 1:750 | CHECKED: ADW | APPROVED: ARW |
| PROJECT No: 70060546 | DESIGNED: ADW | DATE: November 22 |
| DRAWING No: 70060546-WSP-XX-XX-DR-0004 | | REV: P02 |
| © WSP UK Ltd | | |

File name: Y:\PROJECTS\70060546-EWENNY ROAD PRE-PLANNING\DWG\70060546-REMEDIA\DWG_11-November-2022_12:08:00_by:WSPs_Authority