

Figures

**LEGEND**

- Site Boundary copy
- Food Store
- Existing Rising Main

**NOTES:**

Drawing reproduced from client provided Site Strategy Plan (BCB0075634 - Drawing No. A107).

Contains OS data © Crown copyright and database right (2019). Data may be re-used under the terms of the Open Government Licence (OGL).

**SCALE: 1:1000 (approx. @ A3)**

**PROJECT:**  
**PROPOSED RESIDENTIAL DEVELOPMENT - PORTHCAWL, SITE A**





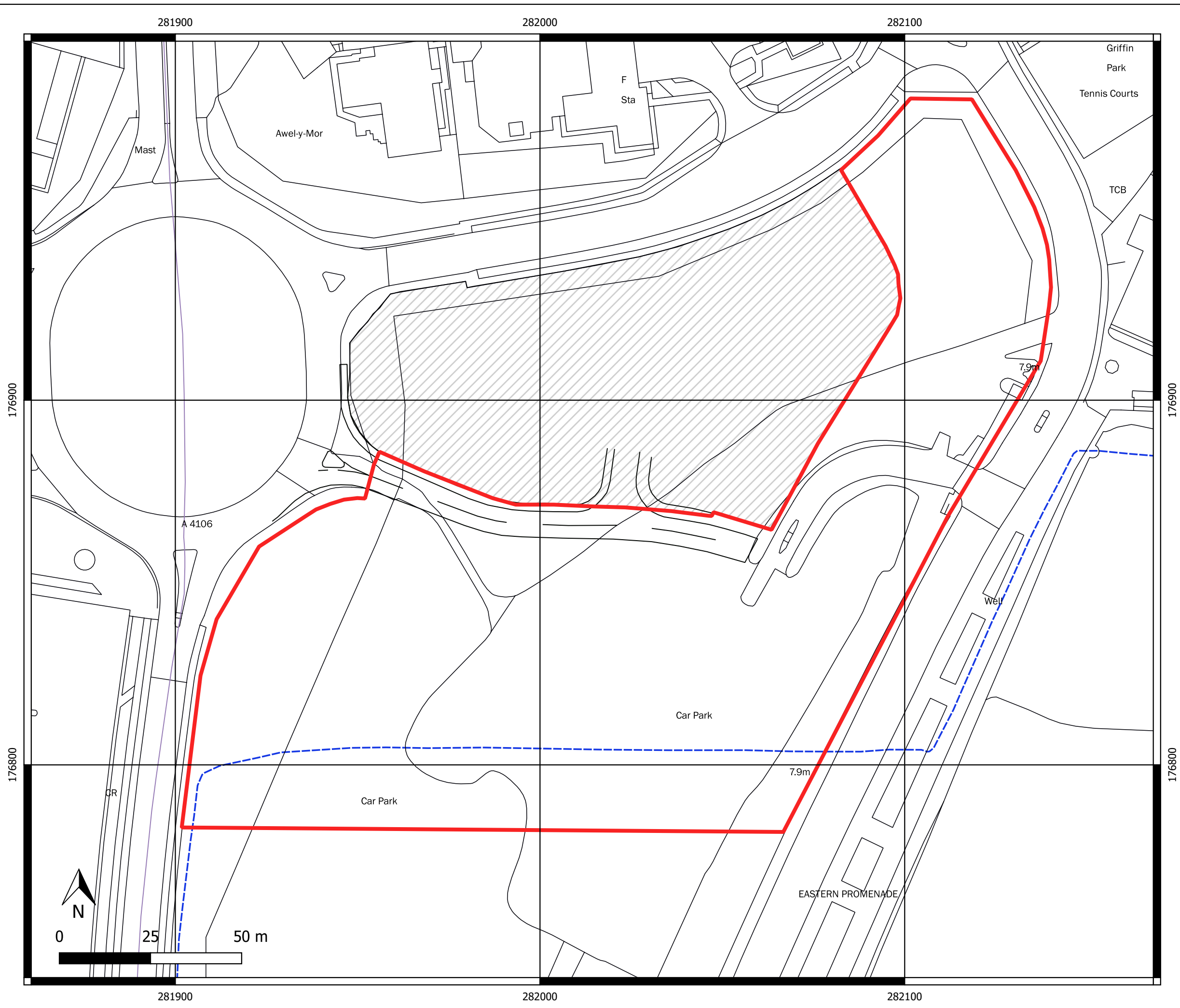





**FIGURE 1:**  
**INDICATIVE 'SITE STRATEGY' PLAN (CLIENT SUPPLIED)**

**EARTH SCIENCE PARTNERSHIP**  
33 Cardiff Road, Taff's Well,  
Cardiff CF15 7RB Tel: 029 2081 3385  
enquiries@earthsciencepartnership.com





**LEGEND**

-  Site Boundary
-  Proposed Food Store
- Historical Site Features**
-  Building (Smithy)
-  Coal Tip
-  Dock Slipway and Masonry Walls
-  Ground Workings
-  Landfill
-  Railway
-  Tank (Unspecified)
-  Infilled Dock

Contains OS data © Crown copyright and database right (2019).  
Data may be re-used under the terms of the Open Government  
Licence (OGL).

**SCALE: 1:1000 (approx. @ A3)**

**PROJECT:**  
**PROPOSED RESIDENTIAL DEVELOPMENT –**  
**PORTHCAWL, SITE A**





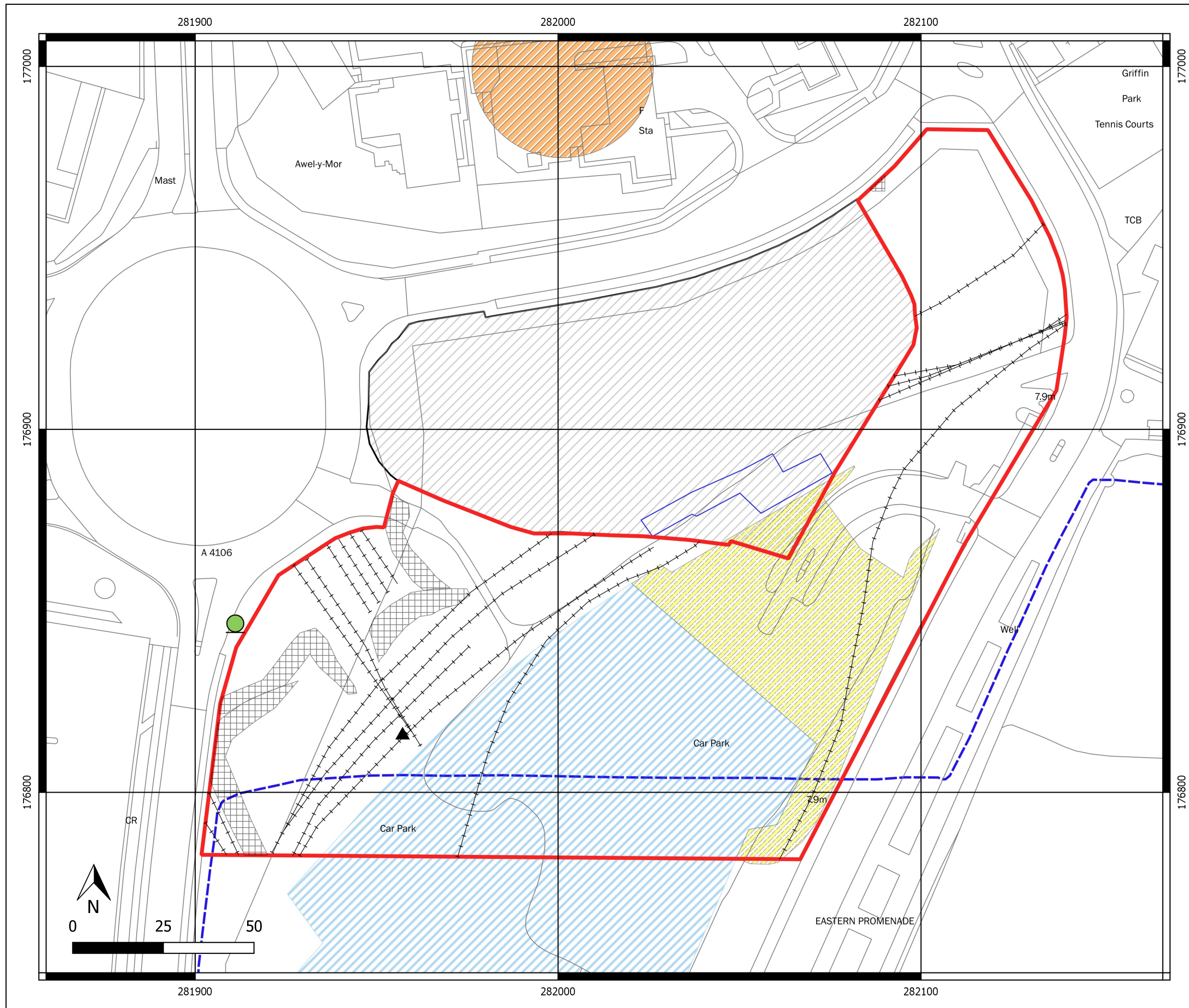







**FIGURE 2:**  
**POTENTIAL HISTORICAL CONTAMINATION**  
**SOURCE PLAN**

**EARTH SCIENCE PARTNERSHIP**  
33 Cardiff Road, Taff's Well,  
Cardiff CF15 7RB Tel: 029 2081 3385  
enquiries@earthsciencepartnership.com





**LEGEND**

-  Site Boundary
  -  Proposed Food Store
  -  Blown Sand Deposits/Limestone Bedrock Potential for running sands /limestone solution
  -  Existing Rising Main
  -  Existing Surface Water Drainage
- Historical Site Features**
-  Building (Smithy)
  -  Coal Tip
  -  Dock Slipway and Masonry Walls
  -  Ground Workings
  -  Landfill
  -  Railway
  -  Infilled Dock

Contains OS data © Crown copyright and database right (2019). Data may be re-used under the terms of the Open Government Licence (OGL).

**SCALE: 1:1000 (approx. @ A3)**

**PROJECT:**  
**PROPOSED RESIDENTIAL DEVELOPMENT - PORTHCAWL, SITE A**

**FIGURE 3:**  
**POTENTIAL GEOTECHNICAL HAZARD PLAN**

**EARTH SCIENCE PARTNERSHIP**  
33 Cardiff Road, Taff's Well,  
Cardiff CF15 7RB Tel: 029 2081 3385  
enquiries@earthsciencepartnership.com

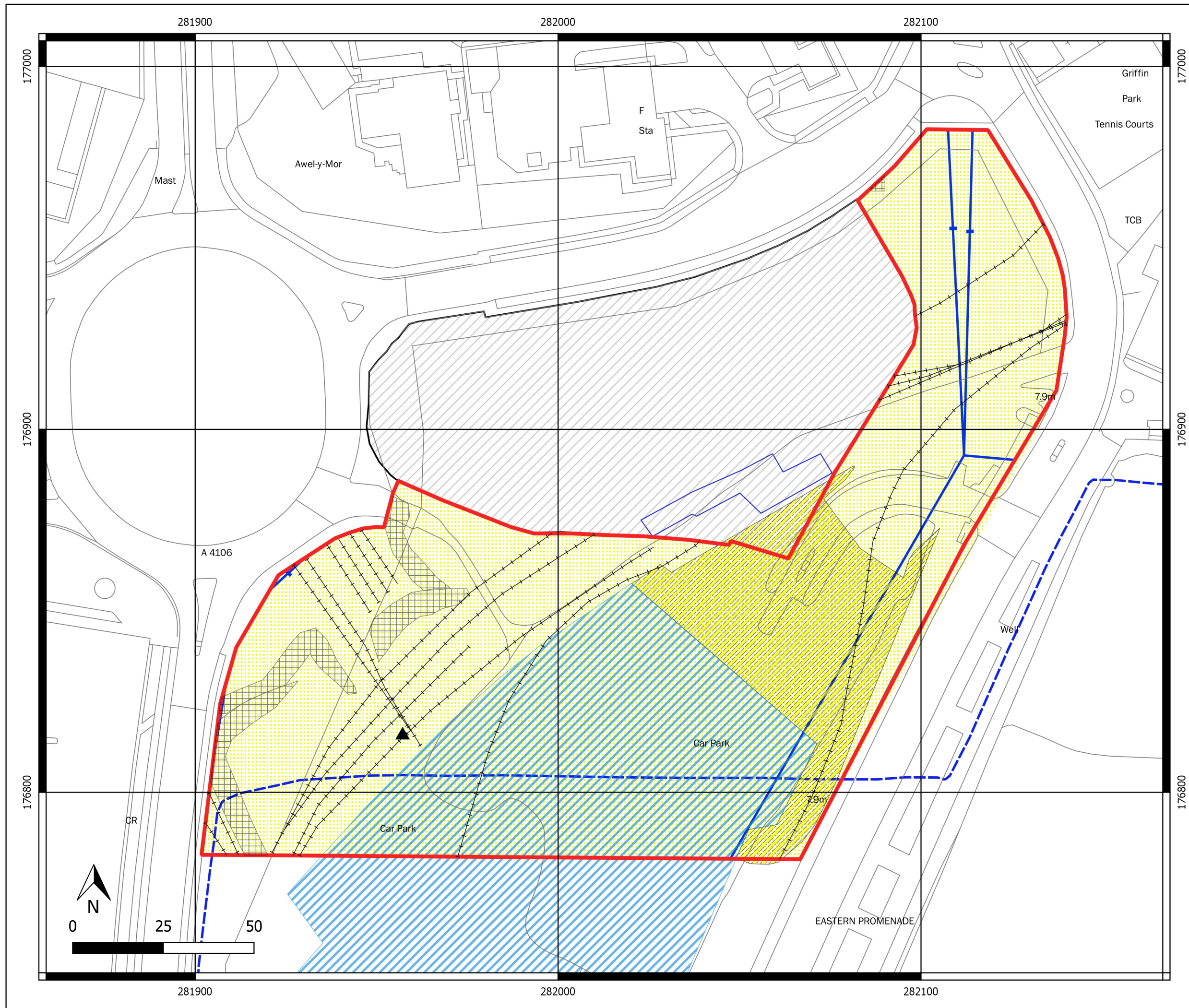



**LEGEND**

- Site Boundary
- Proposed Food Store
- Historic Investigation Points**
- ⊕ Quantum Geotechnical, 2013 (Rotary Drill Hole)
- ⊕ Delta Simmons, 2011 (Windowless Sample Borehole)
- ⊕ Waterman Civils, 2008 (Trial Pit)
- ⊕ Johnson Poole & Bloomer, 1999 (LCP Borehole)
- ⊕ James & Nicholas, 1987 (Trial Pit)
- ⊕ Norwest Holst, 1979 (Borehole)

Contains OS data © Crown copyright and database right (2019). Data may be re-used under the terms of the Open Government Licence (OGL).

**SCALE: 1:1000 (approx. @ A3)**

**PROJECT:**  
**PROPOSED RESIDENTIAL DEVELOPMENT – PORTHCAWL, SITE A**

**FIGURE 4:**  
**PREVIOUS INVESTIGATION POINT PLAN**

**EARTH SCIENCE PARTNERSHIP**  
33 Cardiff Road, Taff's Well,  
Cardiff CF15 7RB Tel: 029 2081 3385  
enquiries@earthsciencepartnership.com

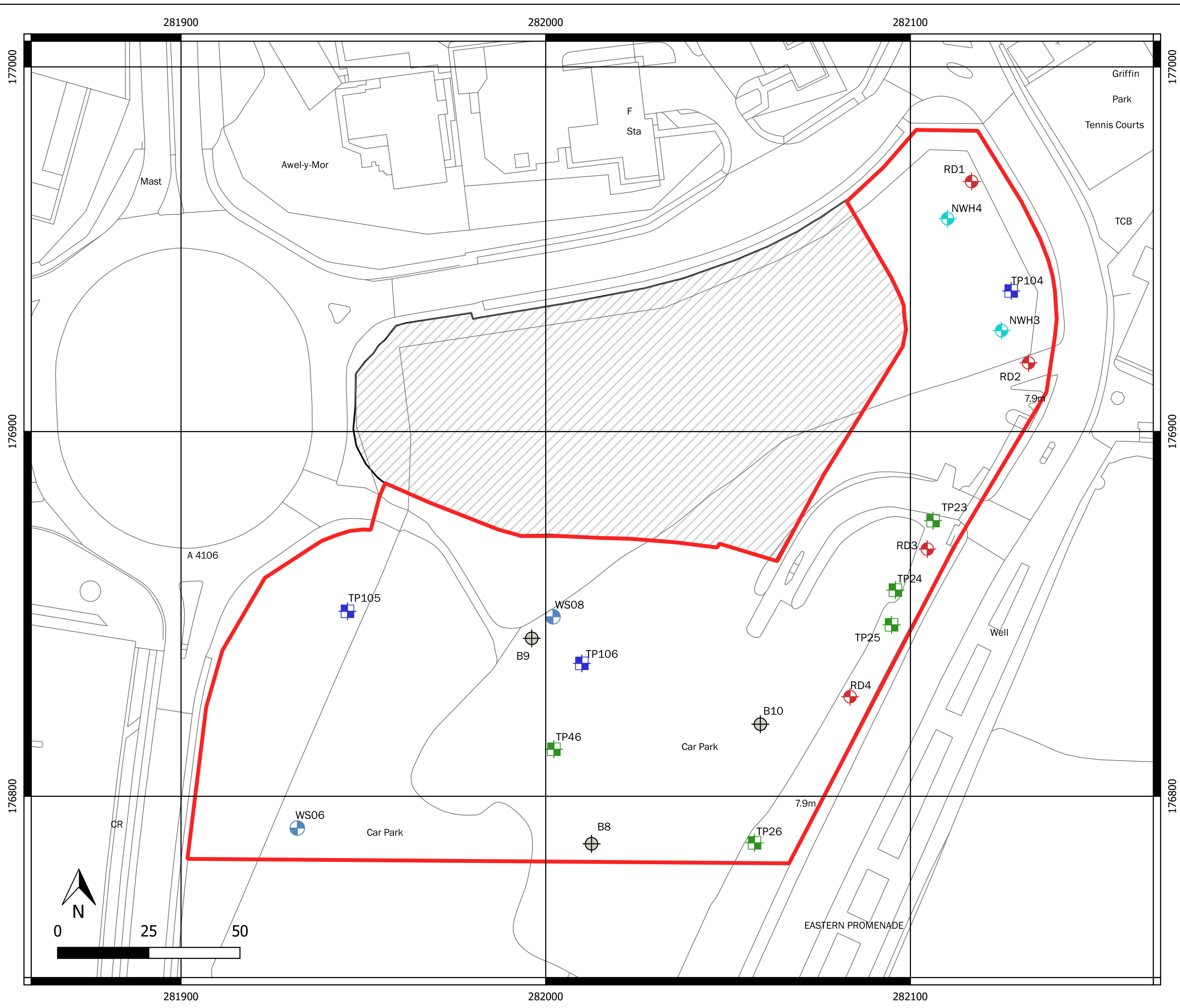



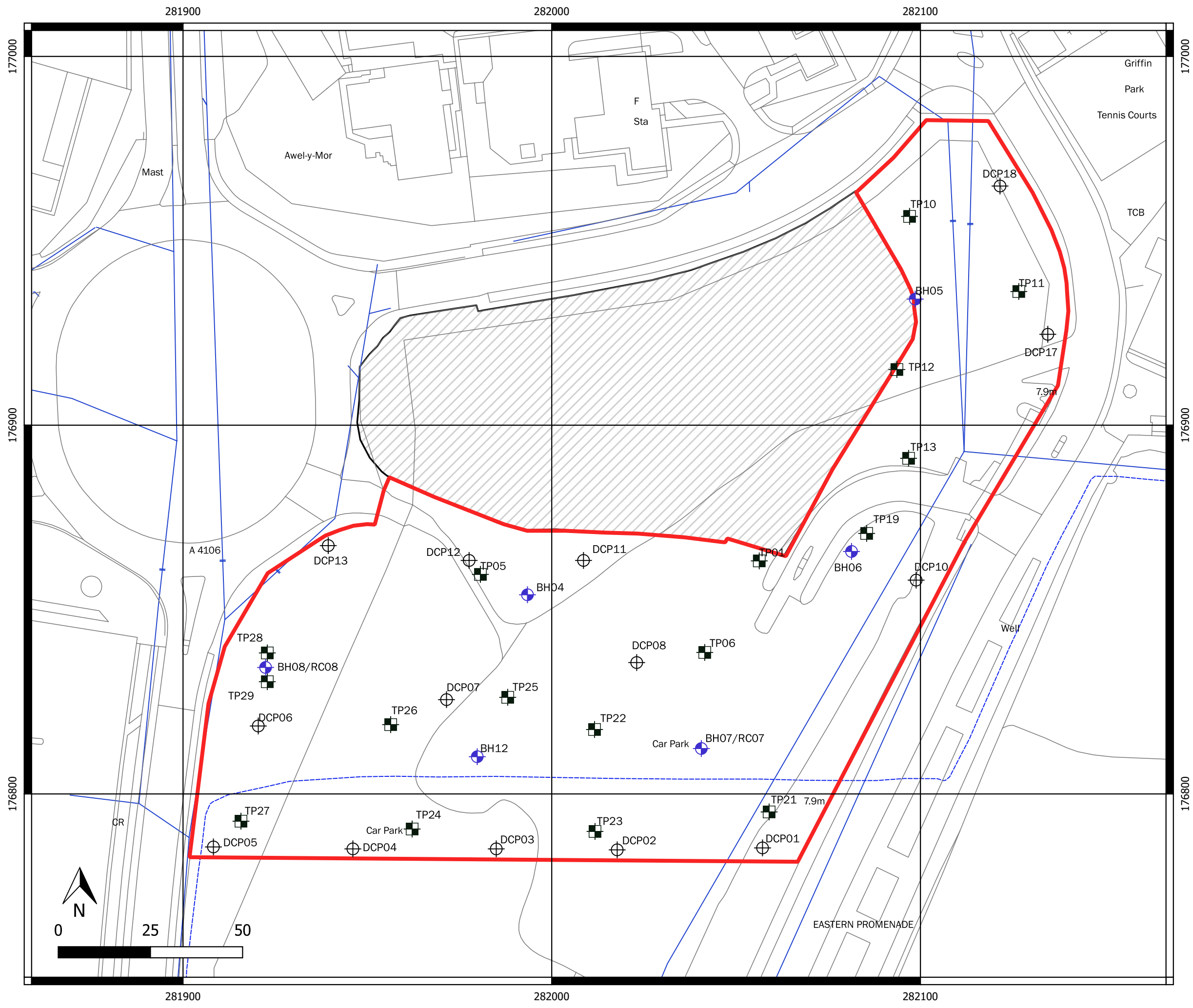

**LEGEND**

- Site Boundary
- Proposed Food Store
- Existing Rising Main
- Surface Water Drainage

**Investigation Points**

- Borehole
- ⊕ DCP
- Trial Pit

Contains OS data © Crown copyright and database right (2019).  
Data may be re-used under the terms of the Open Government Licence (OGL).

**SCALE: 1:1000 (approx. @ A3)**

**PROJECT:**  
**PROPOSED RESIDENTIAL DEVELOPMENT -  
PORTHCAWL, SITE A**

**FIGURE 5:**  
**INVESTIGATION POINT PLAN**

**EARTH SCIENCE PARTNERSHIP**  
33 Cardiff Road, Taff's Well,  
Cardiff CF15 7RB Tel: 029 2081 3385  
enquiries@earthsciencepartnership.com



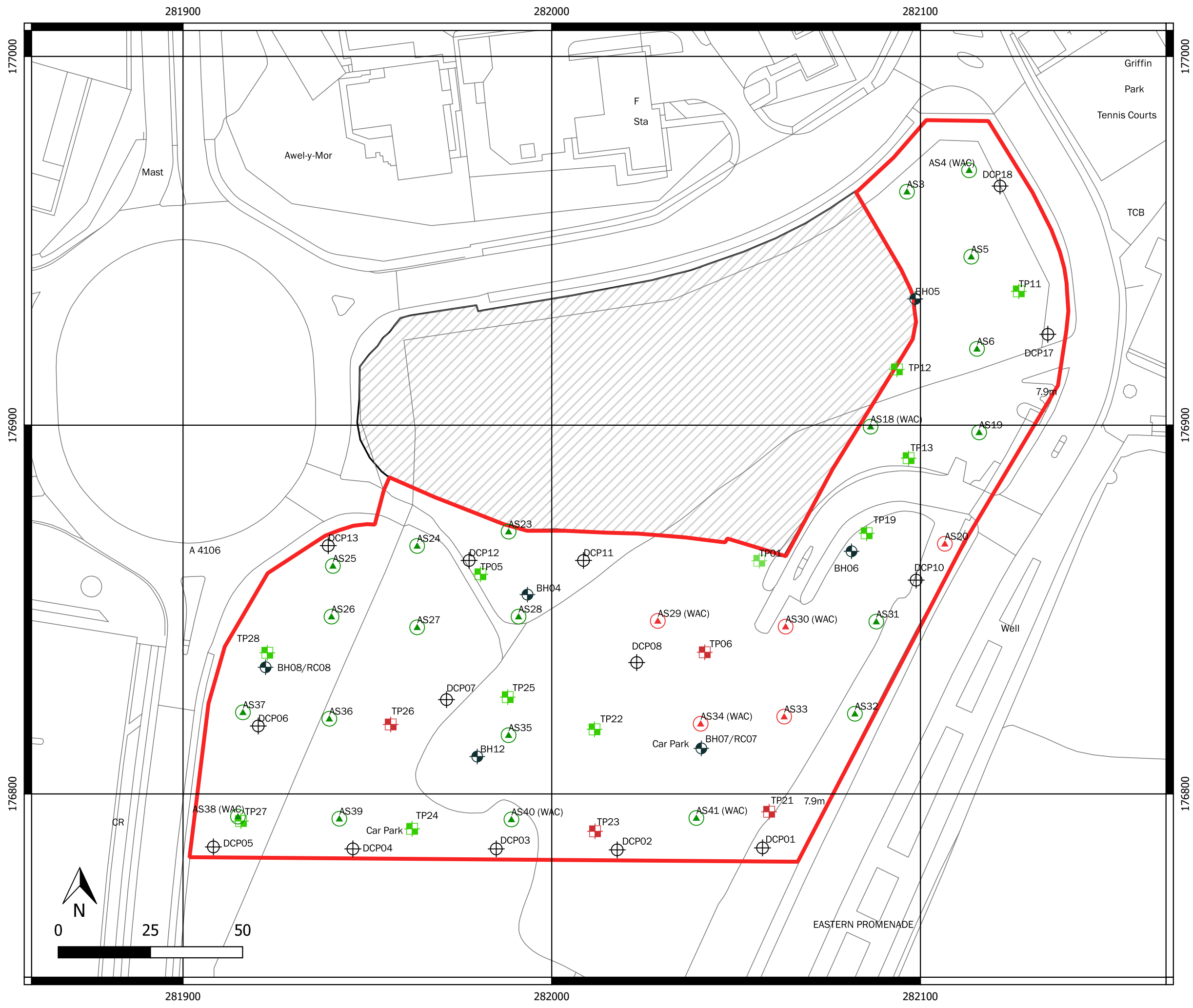

**LEGEND**

- Site Boundary
- Proposed Food Store
- Investigation Points (TP)**
- Borehole
- DCP
- Trial Pit (No Asbestos Identified)
- Trial Pit (Asbestos Identified)
- Supplementary Asbestos Investigation (AS)**
- Trial Pit (No Asbestos Identified)
- Trial Pit (Asbestos Identified)

Contains OS data © Crown copyright and database right (2019).  
Data may be re-used under the terms of the Open Government  
Licence (OGL).

**SCALE: 1:1000 (approx. @ A3)**

**PROJECT:**  
**PROPOSED RESIDENTIAL DEVELOPMENT –**  
**PORTHCAWL, SITE A**

**FIGURE 6:**  
**SUPPLEMENTARY ASBESTOS & WAC**  
**SAMPLING LOCATIONS (ESP, 2019)**

**EARTH SCIENCE PARTNERSHIP**  
33 Cardiff Road, Taff's Well,  
Cardiff CF15 7RB Tel: 029 2081 3385  
enquiries@earthsciencepartnership.com



